



# Tower Court

Prestigious Offices

To Let  
**Last Remaining Suite**

Suite 1 (Ground floor) 1,996 sqft  
10 car parking spaces available

Armley Road, Leeds. LS12 2LY

Forths Forensic Accountants

United Open MRI

Cadogan Information Ltd

Asian Express

Neil Hudgell Solicitors

British Red Cross



# Tower Court

An impressive character building, comprehensively redeveloped to provide modern office accommodation

Set within gated landscaped grounds, Tower Court affords 10 designated, on-site car parking spaces for each suite.

## Location

Prominently located fronting Armley Road (A647), Tower Court enjoys excellent accessibility for Leeds City Centre, as well as the motorway network and is within walking distance of the extensive amenities of Armley Town Street.

Leeds City Centre	1.5 miles
Armley gyratory	0.75 miles
Junction 2, M621	1.26 miles
Armley town centre	0.25 miles
Bradford City Centre	8 miles
Leeds Bradford Airport	6.5 miles

## Accommodation

<b>Ground Floor</b>		
Suite 1	1,996 sq ft	185 sq m
Suite 2	United Open MRI	

<b>First Floor</b>	
Suite 3	Forths Forensic Accountants
Suite 4	United Open MRI

**Parking**  
10 spaces available per suite

## Specification

- Striking entrance reception
- Gas fired central heating
- Carpeted throughout
- Suspended ceilings incorporating recessed lighting
- Excellent natural light
- Perimeter trunking
- Central core with toilet facilities

## Terms

The suite is available to let on flexible terms. Rent on application.

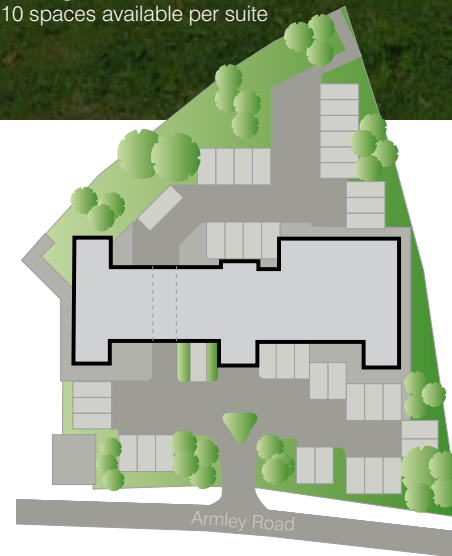
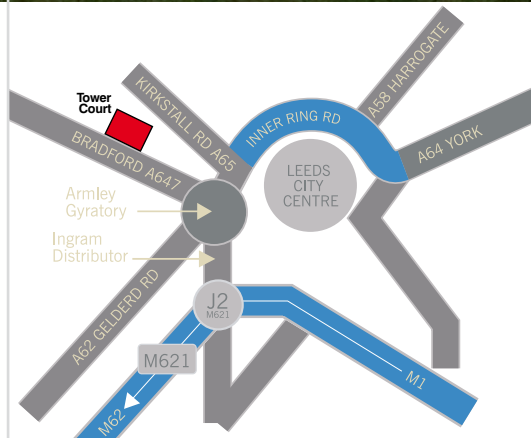

## Viewing & further information

PROPERTY CONSULTANTS  
**wsb**  
www.wsbproperty.co.uk  
**0113 234 1444**

www.cartertowler.co.uk  
**CARTER TOWLER**  
CHARTERED SURVEYORS  
**0113 245 1447**

**MISREPRESENTATION ACT**  
All premises are offered subject to contract and availability. These particulars are issued, without responsibility on the part of the vendor, WSB, Carter Towler or any of their respective employees or agents and serve only as an introductory guide to the premises. No part of them constitutes a term of a contract or a statement or representation upon which any reliance can be placed. Any person with an actual or prospective interest in the premises must satisfy themselves as to any matter concerning the premises by inspection, independent advice or otherwise. Neither WSB, Carter Towler nor any of their employees or agents have any authority to make or give any representation or warranty as to the premises whether in these particulars or otherwise.  
January 2011