

Tower Court

Prestigious Offices



To Let

Last Remaining Suite

Suite 1 (Ground floor) 1,996 sqft
10 car parking spaces available
Armley Road, Leeds. LS12 2LY



Tower Court

An impressive character building, comprehensively redeveloped to provide modern office accommodation

Set within gated landscaped grounds, Tower Court affords 10 designated, on-site car parking spaces for each available suite.



Suite 3



Location

Prominently located fronting Armley Road (A647), Tower Court enjoys excellent accessibility for Leeds City Centre, as well as the motorway network and is within walking distance of the extensive amenities of Armley Town Street.

Leeds City Centre	1.5 miles
Armley gyratory	0.75 miles
Junction 2, M621	1.26 miles
Armley town centre	0.25 miles
Bradford City Centre	8 miles
Leeds Bradford Airport	6.5 miles

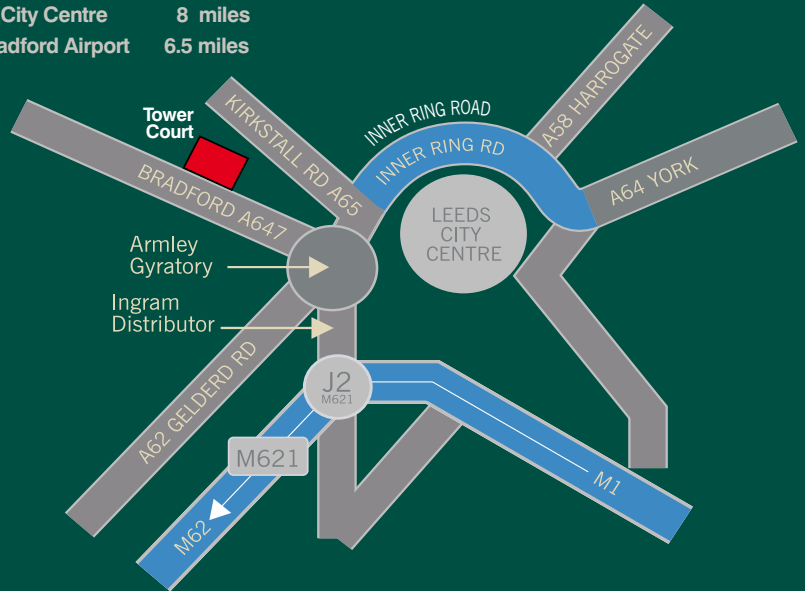

Accommodation

Ground Floor

Suite 1	1,996 sq ft	185 sq m
Suite 2	United Open MRI	

First Floor

Suite 3	Forths Forensic Accountants
Suite 4	United Open MRI

Parking

10 spaces available per suite

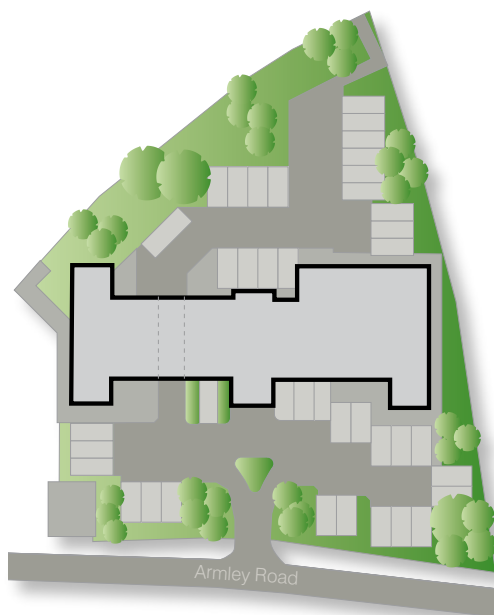

Specification

- Striking entrance reception
- Gas fired central heating
- Carpeted throughout
- Suspended ceilings incorporating recessed lighting
- Excellent natural light
- Perimeter trunking
- Central core with toilet facilities

Terms

The suite is available to let on flexible terms.
Quoting rent £19,960 per annum exclusive.

Viewing & further information



MISREPRESENTATION ACT

All premises are offered subject to contract and availability. These particulars are issued, without responsibility on the part of the vendor, CB Richard Ellis, Carter Towler or any of their respective employees or agents and serve only as an introductory guide to the premises. No part of them constitutes a term of a contract or a statement or representation upon which any reliance can be placed. Any person with an actual or prospective interest in the premises must satisfy themselves as to any matter concerning the premises by inspection, independent advice or otherwise. Neither CB Richard Ellis, Carter Towler nor any of their employees or agents have any authority to make or give any representation or warranty as to the premises whether in these particulars or otherwise.

January 2010